

# COOK'S CABIN

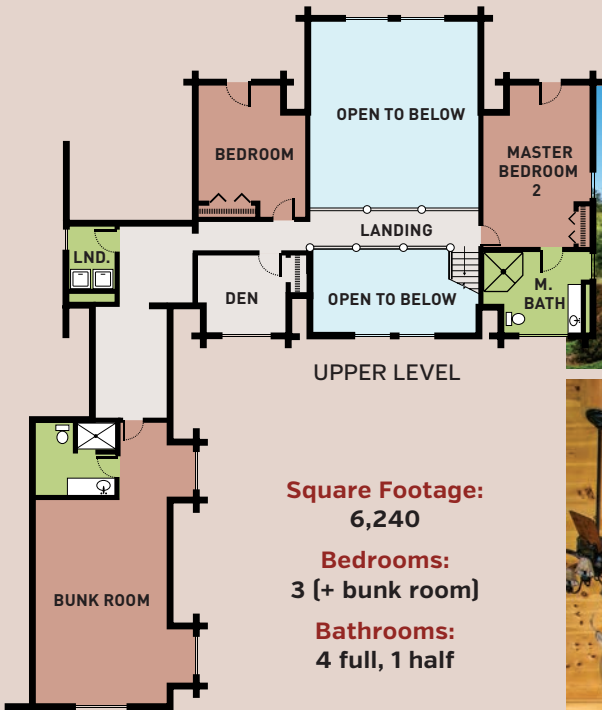

**Square Footage:**  
6,240

**Bedrooms:**  
3 (+ bunk room)

**Bathrooms:**  
4 full, 1 half



**Designed around the owner's vision of the perfect summer getaway, Cook's Cabin has plenty of space, indoor and out, for entertaining and gathering of family.**

The main floor of the home has an impressive, light-filled foyer that leads to a large dining/ kitchen/great room area. The main floor is also equipped with a walk-in pantry, half bath, laundry room, and full master suite. Access to the three car garage is also on this floor.

The second floor has two sections joined by a catwalk - one section has a second master suite, while the other contains a bonus bunkroom with full bath, a small laundry, a den, and a spare bedroom.

The full walkout basement was designed with a bar, a full bath, and a small family room area.



**Estemerwalt**  
LOG HOMES

505 Adams Pond Road  
Honesdale PA 18431  
800-515-2060

e-mail: [homes@estemerwalt.com](mailto:homes@estemerwalt.com)  
[www.estemerwalt.com](http://www.estemerwalt.com)